

Specifications: Ø75 LED 400Lm

Model: COE075A

Paint Cone Mini Downlight -Fixed

remark:

LED Lighting

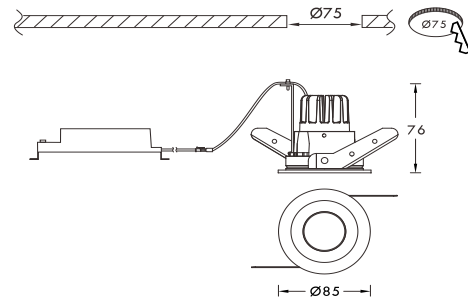

#### ● Specifications ●

Light Source :	Cree COB LED (CMA-1306)
CCT :	2700K / 3000K / 4000K / 5000K (Optional)
CRI :	> 90(Ra)
SDCM :	≤ 3(Step) (±150K)
LED Flux :	591 Lm (±3.5%)
Luminaire Flux :	400 Lm (Use 24° as standard)
Beam Angle :	18°(2246cd) 24°(1453cd) 38°(756cd) 62°(532cd)
LED Power :	5.2W / 150mA
Consumption :	6.9W
In ambient temperature 25°C, only for use at ambient temperatures below 45°C.	
Input Voltage :	100-240V (50~60Hz)
Driver :	2-Stage, Active-PFC(<20W PF>0.9 , >20W PF>0.95 )
	THD<15%, Overload Protection
	Power conversion efficiency 80~90% (>European ErP standard)
	*Proportional to system watt.
Flicker :	Flicker Index ≤0.01, Percent Flicker ≤1% (CIETN006:2016)

#### ● Light Distribution ●

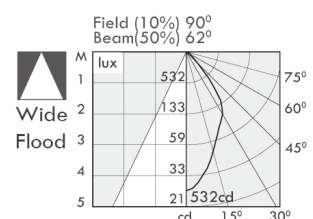
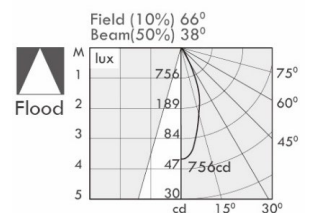
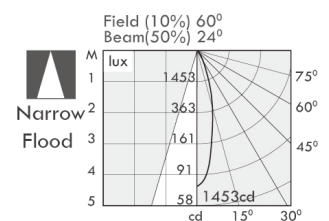
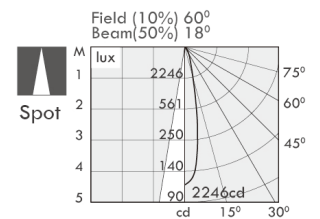

#### ● Safety ●

UGR :	< 19
Ingress Protection:	IP20
Heat sink :	Changeable Die-cast Module
Dimming interface :	DC 0~10V / DALI / PWM / Sub-G(wireless) / Triac (Optional)
Safety Certification :	CNS-14115 、CNS-14335 、CNS-15592 、CE 、CB

#### ● Lifetime ●

Lumen maintenance L90 > 36K Hrs., L70 > 100 K Hrs.( L90/B10 36,000Hrs ).
In ambient temperature-20°C ~45°C (LED manufacturer specifications)
Driver lifetime > 50K Hrs.

#### ● Description ●

Die-cast aluminum heat sink with electro-deposition coating.
Fireproof PC optical lens.
Die-cast aluminum lamp body with liquid painting.
Steel ring with electro-deposit (ED) coating and stainless steel spring clip.
Japanese standard quick plug terminal (applicable to solid conductor cable Ø1.6~2.0mm),
Anti-pull and avoid bad connection.
Modular and quick plug cable design design is easy to install and maintain.

規格說明: Ø75 LED 400Lm

型號: COE075A

小嵌燈系列 - 小白直照

備註:

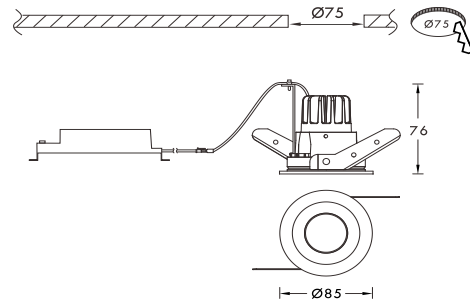

#### ● 規格說明 ●

光源:	Cree COB LED (CMA-1306)
色溫:	2700K / 3000K / 4000K / 5000K(選配)
演色性:	> 90(Ra)
色容差:	≤ 3(Step) (±150K色溫)
LED光通量:	591 流明(Lm) (±3.5%)
燈具光通量:	400 流明(Lm) (以24°為標註)
光束角:	18°(2246cd) 24°(1453cd) 38°(756cd) 62°(532cd)
LED驅動:	5.2W / 150mA
總耗瓦數:	6.9W

以上數據以環境溫度25°C計算，限用環境溫度45°C以下。

輸入電壓:	全電壓，100-240V (50~60Hz)
電子驅動器:	二級架構，隔離型、高功因(<20W PF>0.9, >20W PF>0.95) 總諧波失真(THD)<15%、防突波、防干擾(符合 IEC/EMC 標準)。 電源轉換效率 80~90 % (>歐規ErP標準) *依負載功率成正比
頻閃說明:	頻閃指數(Flicker Index) ≤0.01、頻閃百分比(Percent Flicker) ≤1% (依據CIETN006:2016進行測試)

#### ● Light Distribution ●

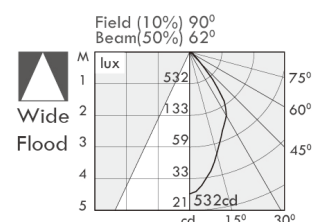
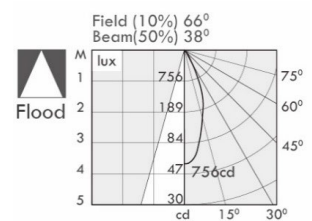
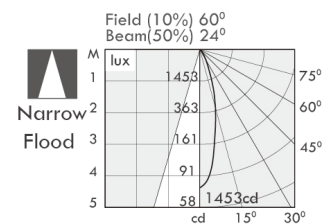
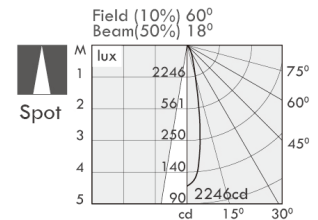

#### ● 安規說明 ●

UGR:	< 19
防護等級:	IP20
散熱模式:	可替換式鋁合金壓鑄COB光源模組
調光模式:	DC 0~10V / DALI / PWM / Sub-G(wireless) / Triac (可選配)
安規認證:	CNS-14115、CNS-14335、CNS-15592、CE、CB

#### ● 壽命說明 ●

環境溫度-20°C ~45°C，光束維持率L90(降至90%的光通量)>5萬小時，L70>15萬小時。

(光源依據美國能源之星LM80檢測標準)。

電子驅動器在環境溫度-20°C ~45°C推估可>5萬小時。

#### ● 結構說明 ●

鋁鎂合金壓鑄成型散熱鱗片，黑色電著處理。

高透光率防火PC可替換式菲涅爾透鏡。

鋁壓鑄成型燈體，高溫液體烤漆處理。

鋼材成型外框，黑色電著處理，不鏽鋼材固定彈片。

日規快插接線端台(適用單芯線 Ø1.6~2.0mm)，防拉扯與避免接觸不良。

模組化及快插結線，容易安裝換修。